





# Chinook Care Centre PHASE-2 IMPACT CALENDAR for Dec-20/2020 – Jan-9/2021

Sun	Monday	Tuesday	Wednesday	Thursday	Friday	Sat
Dec-20 W k 94	Dec-21 <i>C</i>	Dec-22 <i>C</i>	Dec-23 <i>C</i>			Dec-26 HAPPY BOXING DAY! 
	➤ Buttoning-Up For Christmas Break					
Dec-27 W k 95	Dec-28 <i>C</i>	Dec-29 <i>C</i>	Dec-30 <i>C</i>	Dec-31 <i>C</i>	Jan-1 <i>C</i> 	Jan-2
	➤ somewhat slow between Christmas & New Years, but carrying-on					
Jan-3 W k 96	Jan-4 <i>C</i>	Jan-5 <i>C</i>	Jan-6 <i>C</i>	Jan-7 <i>C</i>	Jan-8 <i>C</i>	Jan-9
	➤ Roof Top Units 1 and 2 Assembly & Connections   ➤ Mech & Elec Finishes ➤ Millwork   ➤ Painting, Wallpaper & Flooring   ➤ Elevator Installs ➤ Exterior Finishes   ➤ Connection Point Construction   ➤ Drywalling					



## IMPACT EVENTS

- |  |                                       |
|--|---------------------------------------|
| <i>P</i> Parkade Access Disruptions    | <i>S</i> Staff Area Disruptions       |
| <i>A</i> Building Access Interruptions | <i>E</i> Planned Electrical Shut Down |
| <i>C</i> Construction Activity         | <i>W</i> Planned Water Shut Down      |
| <i>R</i> Resident Area Disruptions     | <i>N</i> Excess Noise                 |

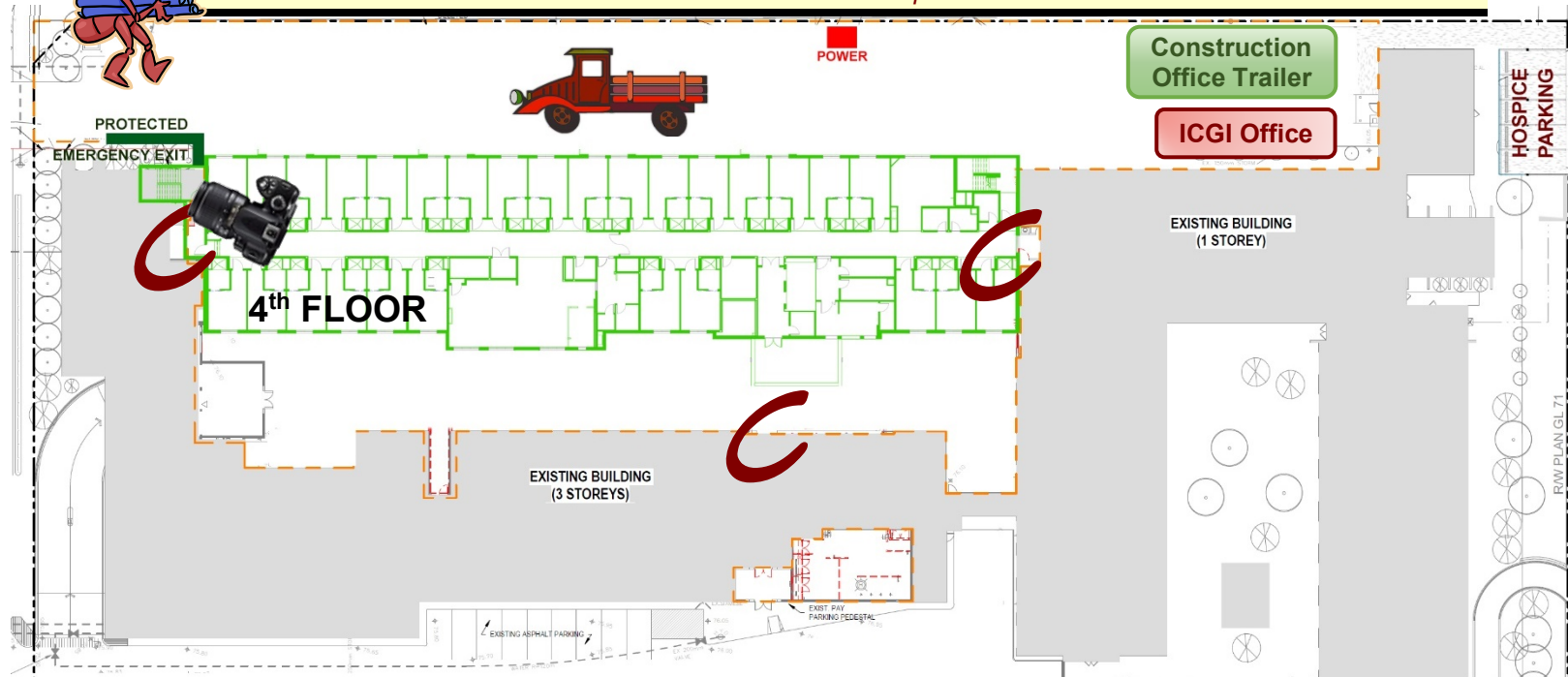

Dec-18/2020

Stairway-2 Extension to 4<sup>th</sup> Floor

